

# Mission:

## Piper Make Robotic Walker

### SIDE A Assembly

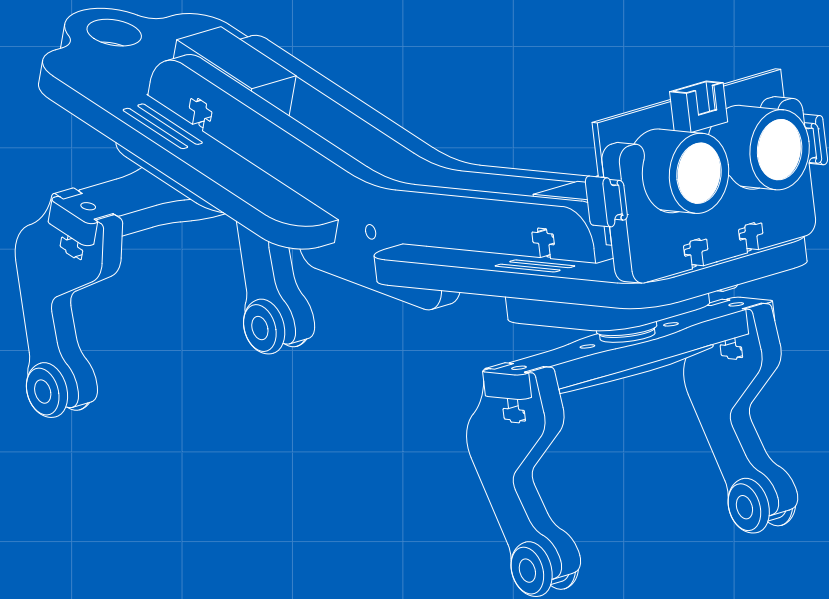

**1** ●○○○○○

Repeat 4× to install Grommets onto each Leg

**2** ●●○○○○

Repeat 2× to attach Spline Horn to each Servo Horn with Screws

Attach Legs to Servo Horn with Screws and Nuts

Repeat 2× with all four legs

! Make sure the Spline Horn is facing downwards

**3** ●●●○○○

Install the Spines on both the Torso and Trunk

**4** ●●●●○○

Install Torso and Trunk Servos so motors are facing OUTWARDS

Do not overtighten the screws

**NOTE**

The "knees" should face towards the tail of Walker, like a dog.

### INVENTORY

- |                |                                  |
|----------------|----------------------------------|
| 1 Torso        | 2 FS90 Servo Motor               |
| 1 Trunk        | 6 3/8" #4-40 Screws (A)          |
| 4 Legs         | 2 Small Screws (B)               |
| 4 Grommet      | 4 3/4" #4-40 Screws (C)          |
| 2 Servo Horn   | 4 1/4" #4-40 Screws (D)          |
| 2 Servo Holder | 10 #4-40 Hex Nuts                |
| 2 Spine        | 1 Ultrasonic Range Finder        |
| 2 Spline Horn  | 1 Ultrasonic Range Finder Holder |
| 1 O-Ring       |                                  |

**5** ●●●●●○

Use O-Ring to attach Range Finder to Holder

Insert Holder into Walker torso

### ASSEMBLY COMPLETE!

Head to Piper Make to continue your mission

[make.playpiper.com](http://make.playpiper.com) →

# Mission:

## Piper Make Robotic Walker

### SIDE B

Disassembly

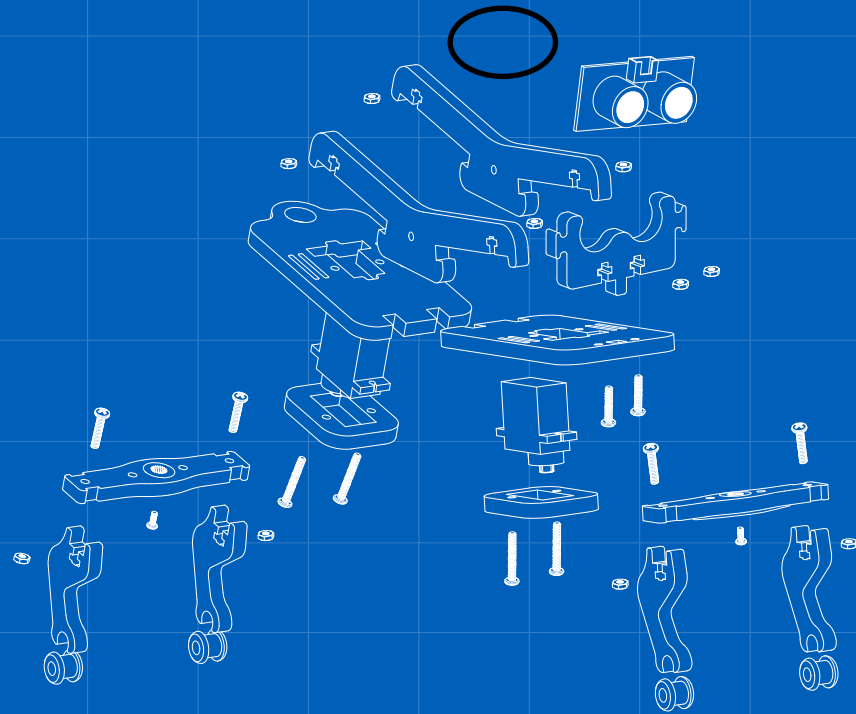

### INVENTORY

- |                |                                  |
|----------------|----------------------------------|
| 1 Torso        | 2 FS90 Servo Motor               |
| 1 Trunk        | 6 3/8" #4-40 Screws (A)          |
| 4 Legs         | 2 Small Screws (B)               |
| 4 Grommet      | 4 3/4" #4-40 Screws (C)          |
| 2 Servo Horn   | 4 1/4" #4-40 Screws (D)          |
| 2 Servo Holder | 10 #4-40 Hex Nuts                |
| 2 Spine        | 1 Ultrasonic Range Finder        |
| 2 Spline Horn  | 1 Ultrasonic Range Finder Holder |
| 1 O-Ring       |                                  |

### 1 ●○○○○○

**A** Remove Screws and Nut

Detach Holder from Walker Torso

Remove O-Ring to detach Range Finder from Holder

Place each item on its spot on the Components sheet

### 2 ●●○○○○

**B** Detach Legs by removing Screws

**C** Uninstall Servo Motors by removing the Screws and Nuts

### 3 ●●●○○○

Detach the Spines from both the Torso and Trunk

### 4 ●●●●○○

**A** Deattach Legs from Servo Horn by removing Screws and Nuts

Repeat 2x with all four legs

### 5 ●●●●●○

Remove Grommet from each Leg

Repeat 4x

## DISASSEMBLY COMPLETE!

If not already done, place each piece on its spot on the Components sheet

# Mission:

## Piper Make Robotic Walker

### Components Sheet

Gather and organize your supplies



Legs x 4

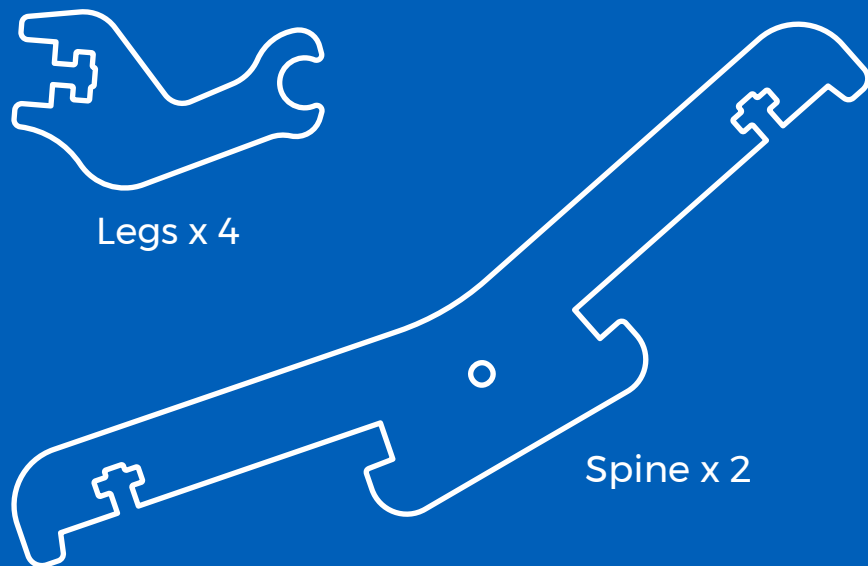

Spine x 2

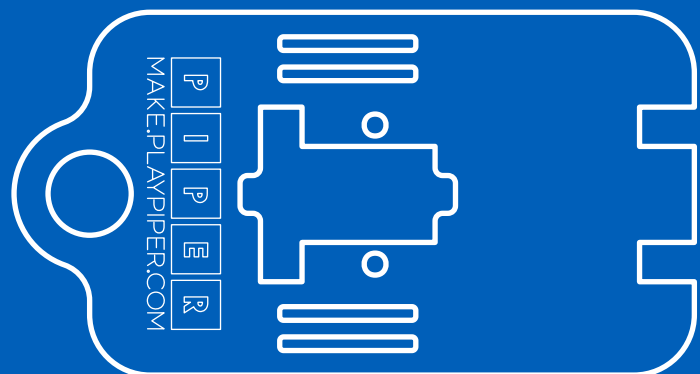

Trunk x 1

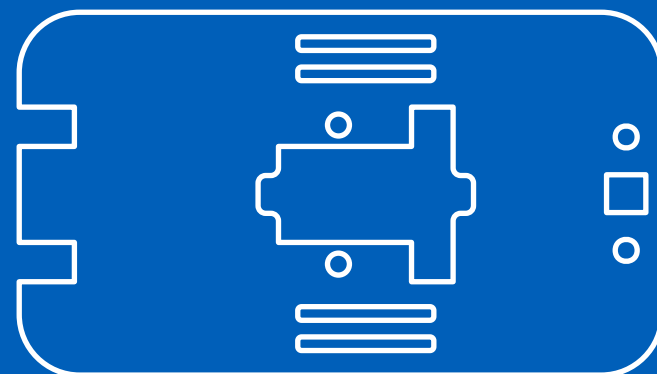

Torso x 1

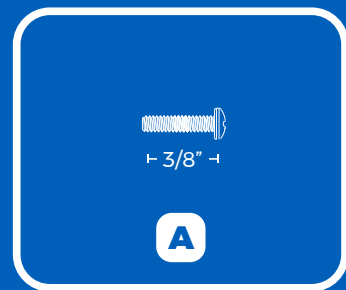

#4-40 Screw x 6

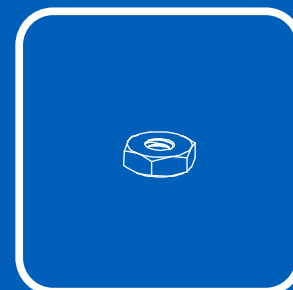

#4-40 Nut x 10

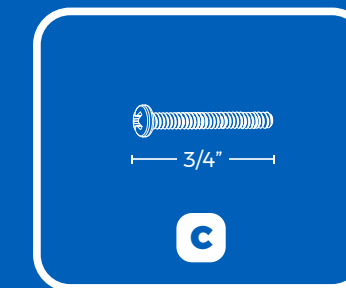

#4-40 Screw x 4

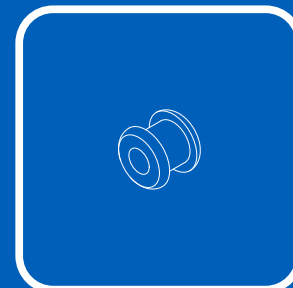

Grommet x 4

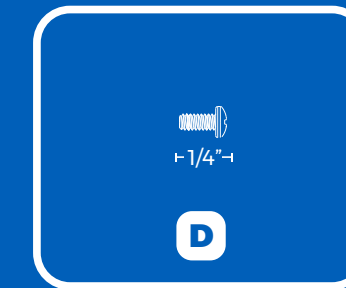

#4-40 Screw x 4

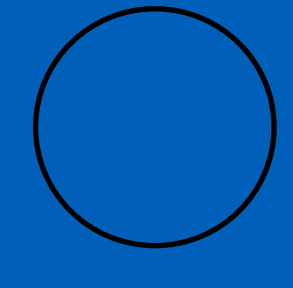

O-Ring x 1



Servo Horn x 2

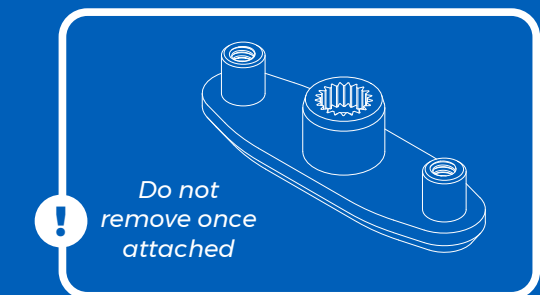

Spline Horn x 2

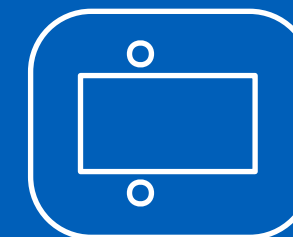

Servo Holder x 2

### Servo Motors

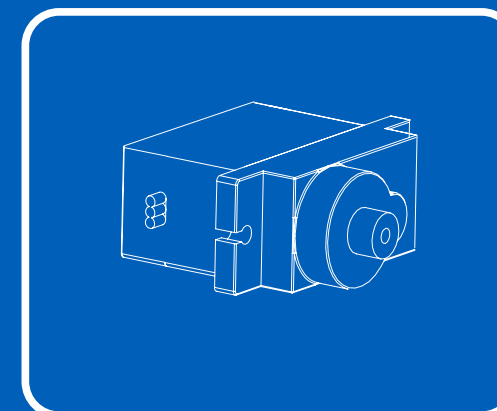

FS90R Servo Motor x 2

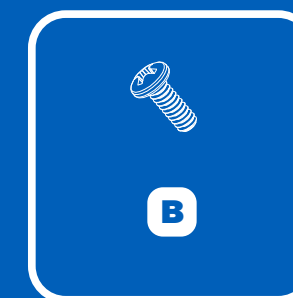

Small Screws x 2

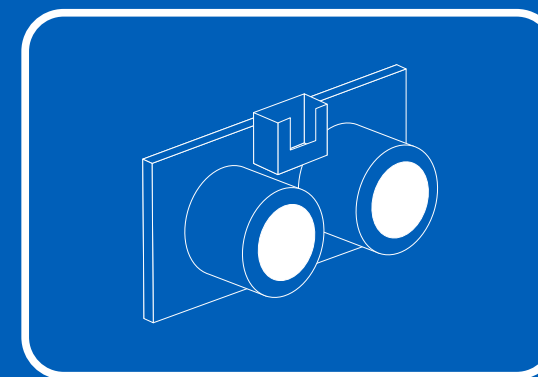

Ultrasonic Range Finder x 1